

Conveyor Head Roller Magnet



Installed at the discharge end of flat or trough belt conveyors, Head Rollers are designed to remove tramp iron and small pieces of iron that cannot be attracted using either an Overband or Plate magnet due to deep product depths.

Used in conjunction with the above mentioned units, Head Roller Magnets will give you the best possible protection against tramp metals.

Eclipse Head Rollers are available in two strengths, standard strength for the removal of large pieces of tramp iron or high strength for removing both

large and small pieces of tramp.

As the contamination enters the roller's magnetic field it is attracted and held firmly on the belt until it reaches the underside where it passes out of the magnetic field and is discharged separately from the conveyed product which continues on its normal trajectory.

Rollers are supplied complete with shaft bearings for ease of installation, where conveyor bearings already exist, shaft details can be machined to suit. Parallel, crown or rubber coated faces are all available and should be specified at time of order.

Main features and benefits:

- Available in two magnetic strengths.

Standard Strength

Designed to remove large tramp iron contamination.

High Strength

Designed to remove smaller ferrous contamination.

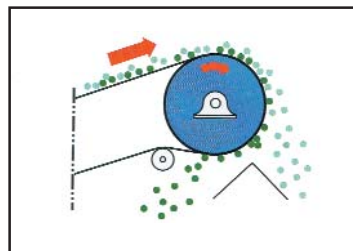

- Continuously cleaning when belt is running.
- Custom built units available upon request.
- Provides ultimate protection from a wide range of product contaminants.
- Quick and easy to install. Once in position, you know it's definitely working.
- Totally maintenance free, no power supply, no running costs.
- Supplied with full test certificates.
- Guarantee on magnetic performance.

Eclipse Magnetics has a full range of magnetic separators to cover all applications. Many separators can be tailor-made to exactly suit existing process pipeline and duct work.

Technical Specifications

Magnetic Performance: Standard Strength 1,000 Gauss
High Strength 3,500 Gauss

Magnetic Material: Ceramic Material(1,000 Gauss).
High Energy 'Rare Earth' Neodymium Iron Boron (3,500) Gauss.

Material Specification: Outer shell rolled 304 grade Stainless Steel.

Limitations: Conveyor Head Roller Magnets, are not dynamically balanced and therefore should not be rotated any greater than 50RPM.

Rare Earth

Ceramic

Part No	Dia A (mm)	B (mm)	Dia C (mm)	Dia D (mm)	Weight (kg)
HRN2140	215	400	40	30	68
HRN2150	215	500	40	30	82
HRN2160	215	600	40	30	96
HRN2170	215	700	40	30	110
HRN2180	215	800	40	30	130
HRN21100	215	1000	40	30	160
HRN3140	315	400	50	40	110
HRN3150	315	500	50	40	129
HRN3160	315	600	50	40	148
HRN3170	315	700	50	40	168
HRN3180	315	800	50	40	187
HRN31100	315	1000	50	40	225

Part No	Dia A (mm)	B (mm)	Dia C (mm)	Dia D (mm)	Weight (kg)
HRC2140	215	400	40	30	64
HRC2150	215	500	40	30	77
HRC2160	215	600	40	30	90
HRC2170	215	700	40	30	104
HRC2180	215	800	40	30	123
HRC21100	215	1000	40	30	151
HRC3140	315	400	50	40	125
HRC3150	315	500	50	40	148
HRC3160	315	600	50	40	171
HRC3170	315	700	50	40	194
HRC3180	315	800	50	40	217
HRC31100	315	1000	50	40	271

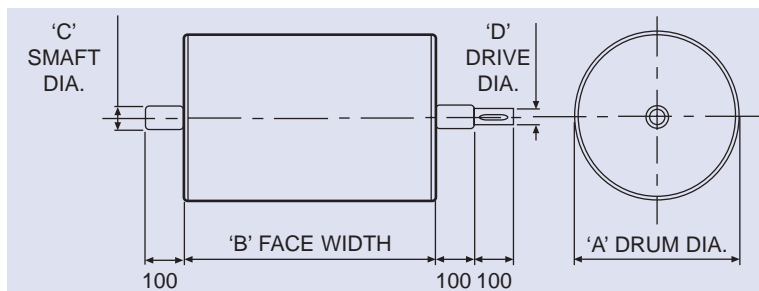

NB When ordering please specify whether roller requires rubber lagging, an additional cost will apply. Performance figures relate to S/Steel clad Rolls. For special applications please call our Technical Department for advice.



*If it's Magnetic
....Then it's Eclipse Magnetics*

Eclipse Magnetics Ltd - Separation Division
Unit 1 Vulcan Road, Sheffield, S9 1EW, England

Tel: 0114 225 0555
Fax: 0114 225 0525

E-mail: sales@eclipse-magnetics.co.uk Web Site: www.eclipse-magnetics.co.uk